



## Fennel Close , Barming ME16 0SZ

- Rare Ragstone House
- En-suite To Master Bedroom
- Popular Queens Road Location
- Grade II Listed Conversion
- Two Off Street Parking Spaces

**Asking Price £425,000 Freehold**



Local Authority Maidstone  
Borough Council  
Council Tax Band E  
EPC Rating D

## Queens House, Fennel Close, Maidstone, ME16

Approximate Area = 1120 sq ft / 104 sq m

For identification only - Not to scale

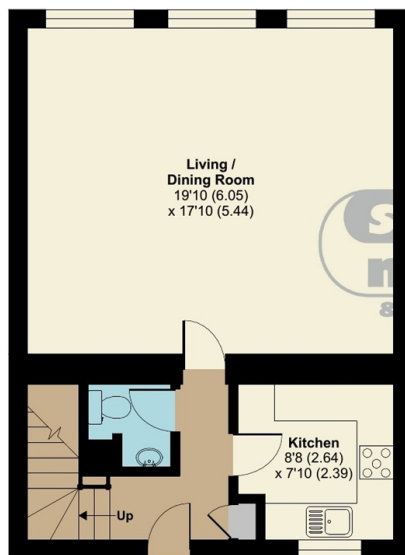

GROUND FLOOR

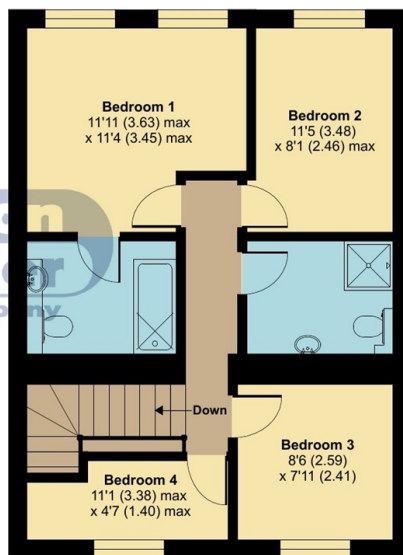

FIRST FLOOR



Floor plan produced in accordance with RICS Property Measurement Standards incorporating International Property Measurement Standards (IPMS2 Residential). © nichecom 2022. Produced for Simon Miller & Company. REF: 816023

### Maidstone & The Weald Office

11 Colman House, Colman Parade, King  
Street, Maidstone, Kent, ME14 1DN

### Contact

01622 691255  
maidstonesales@simonmiller.co.uk

Agents Note: Whilst every care has been taken to prepare these particulars, they are for guidance purposes only. All measurements are approximate and for general guidance purposes only and whilst every care has been taken to ensure accuracy, they should not be relied upon and potential buyers/tenants are advised to recheck the measurements.

